

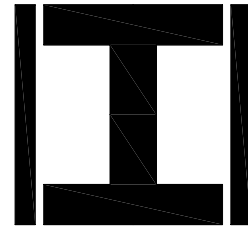

Type Name: SDRH-R Series

Construction/磁气构造图



Dimensions/外形尺寸图(Unit:mm)

Land patterns/贴装尺寸

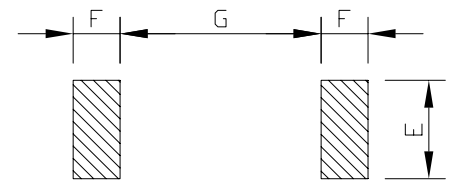
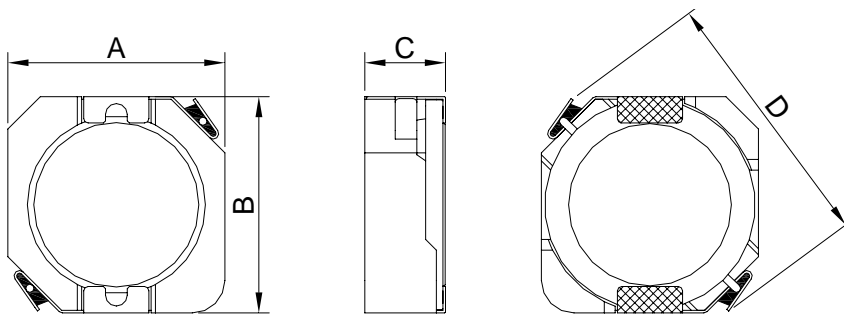

SHAPE AND SIZE:(Dimensions are in mm)

Type Name/型名	A	B	C	D	E	F	G	QTY pcs/reel 包装数量
SDRH103R	10.0±0.3	10.2±0.3	2.8±0.3	13.5MAX	3.2REF	1.6REF	7.3REF	1000
SDRH104R	10.0±0.3	10.2±0.3	3.8±0.2	13.5MAX	3.2REF	1.6REF	7.3REF	1000
SDRH1045R	10.0±0.5	10.3±0.5	4.5MAX	13.5MAX	3.4REF	1.8REF	7.5REF	800
SDRH105R	10.0±0.3	10.2±0.3	4.8±0.2	13.5MAX	3.2REF	1.6REF	7.3REF	500



Specifications/规格

TYPE NAME: SDRH103R				
Part No./品名	Inductance/ 电感值 (μ H)	Test Condition/ 测试条件	D.C.R./ 直流阻抗 ($m\Omega$)MAX.	Saturation Current/ 饱和电流(A)
SDRH103R-0R8NC	0.8 \pm 30%	100KHz,1V	11.4	11.20
SDRH103R-1R5NC	1.5 \pm 30%	100KHz,1V	14.7	8.00
SDRH103R-2R2NC	2.2 \pm 30%	100KHz,1V	16.9	6.70
SDRH103R-3R3NC	3.3 \pm 30%	100KHz,1V	21	5.56
SDRH103R-4R7NC	4.7 \pm 30%	100KHz,1V	30	4.65
SDRH103R-6R8NC	6.8 \pm 30%	100KHz,1V	35	3.84
SDRH103R-8R2NC	8.2 \pm 30%	100KHz,1V	50	3.54
SDRH103R-100MC	10 \pm 20%	100KHz,1V	59	3.18
SDRH103R-150MC	15 \pm 20%	100KHz,1V	91	2.60
SDRH103R-220MC	22 \pm 20%	100KHz,1V	143	2.16
SDRH103R-330MC	33 \pm 20%	100KHz,1V	202	1.74
SDRH103R-470MC	47 \pm 20%	100KHz,1V	299	1.43
SDRH103R-560MC	56 \pm 20%	100KHz,1V	325	1.36
SDRH103R-680MC	68 \pm 20%	100KHz,1V	429	1.22
SDRH103R-820MC	82 \pm 20%	100KHz,1V	494	1.14
SDRH103R-101MC	100 \pm 20%	100KHz,1V	683	1.02
SDRH103R-121MC	120 \pm 20%	100KHz,1V	754	0.89
SDRH103R-151MC	150 \pm 20%	100KHz,1V	871	0.84

※ The saturation current when the inductance decreases to 65% of initial value. (Ta=25°C)



Specifications/规格

TYPE NAME: SDRH104R				
Part No./品名	Inductance/ 电感值 (μ H)	Test Condition/ 测试条件	D.C.R./ 直流阻抗 ($m\Omega$)MAX.	Saturation Current/ 饱和电流(A)
SDRH104R-1R5NC	1.5 \pm 30%	100KHz,1V	8.1	10.0
SDRH104R-2R5NC	2.5 \pm 30%	100KHz,1V	10.5	7.50
SDRH104R-3R8NC	3.8 \pm 30%	100KHz,1V	16	6.00
SDRH104R-5R2NC	5.2 \pm 30%	100KHz,1V	22	5.50
SDRH104R-7R0NC	7.0 \pm 30%	100KHz,1V	30	4.80
SDRH104R-100NC	10 \pm 30%	100KHz,1V	35	4.40
SDRH104R-120NC	12 \pm 30%	100KHz,1V	46	3.70
SDRH104R-150NC	15 \pm 30%	100KHz,1V	55	3.60
SDRH104R-180NC	18 \pm 30%	100KHz,1V	69	3.10
SDRH104R-220NC	22 \pm 30%	100KHz,1V	73	2.90
SDRH104R-270NC	27 \pm 30%	100KHz,1V	93	2.60
SDRH104R-330NC	33 \pm 30%	100KHz,1V	123	2.30
SDRH104R-390NC	39 \pm 30%	100KHz,1V	127	2.20
SDRH104R-470NC	47 \pm 30%	100KHz,1V	155	2.10
SDRH104R-560NC	56 \pm 30%	100KHz,1V	188	1.65
SDRH104R-680NC	68 \pm 30%	100KHz,1V	213	1.50
SDRH104R-820NC	82 \pm 30%	100KHz,1V	283	1.45
SDRH104R-101NC	100 \pm 30%	100KHz,1V	350	1.35
SDRH104R-121NC	120 \pm 30%	100KHz,1V	430	1.20
SDRH104R-151NC	150 \pm 30%	100KHz,1V	506	1.15
SDRH104R-181NC	180 \pm 30%	100KHz,1V	568	1.00
SDRH104R-221NC	220 \pm 30%	100KHz,1V	756	0.95
SDRH104R-271NC	270 \pm 30%	100KHz,1V	853	0.84
SDRH104R-331NC	330 \pm 30%	100KHz,1V	1090	0.70

※ The saturation current when the inductance decreases to 65% of initial value. (Ta=25℃)



Specifications/规格

TYPE NAME: SDRH1045R				
Part No./品名	Inductance/ 电感值 (μ H)	Test Condition/ 测试条件	D.C.R./ 直流阻抗 ($m\Omega$)MAX.	Saturation Current/ 饱和电流(A)
SDRH1045R-1R2PC	1.2 \pm 25%	100KHz,1V	10.4	7.2
SDRH1045R-1R8PC	1.8 \pm 25%	100KHz,1V	12.2	6.6
SDRH1045R-2R7PC	2.7 \pm 25%	100KHz,1V	14.1	6.0
SDRH1045R-3R9PC	3.9 \pm 25%	100KHz,1V	16.6	5.8
SDRH1045R-5R6PC	5.6 \pm 25%	100KHz,1V	23.2	4.8
SDRH1045R-6R8PC	6.8 \pm 25%	100KHz,1V	25.1	4.6
SDRH1045R-8R2PC	8.2 \pm 25%	100KHz,1V	31.0	4.2
SDRH1045R-100MC	10 \pm 20%	100KHz,1V	32.7	4.1
SDRH1045R-120MC	12 \pm 20%	100KHz,1V	47.2	3.2
SDRH1045R-150MC	15 \pm 20%	100KHz,1V	56.1	3.1
SDRH1045R-220MC	22 \pm 20%	100KHz,1V	73.9	2.7
SDRH1045R-330MC	33 \pm 20%	100KHz,1V	120.0	2.0
SDRH1045R-470MC	47 \pm 20%	100KHz,1V	160.4	1.7
SDRH1045R-560MC	56 \pm 20%	100KHz,1V	175.8	1.6
SDRH1045R-680MC	68 \pm 20%	100KHz,1V	217.3	1.4
SDRH1045R-820MC	82 \pm 20%	100KHz,1V	273.8	1.2
SDRH1045R-101MC	100 \pm 20%	100KHz,1V	344.5	1.1

※ The saturation current when the inductance decreases to 65% of initial value. (Ta=25°C)



Specifications/规格

TYPE NAME: SDRH105R				
Part No./品名	Inductance/ 电感值 (μ H)	Test Condition/ 测试条件	D.C.R./ 直流阻抗 (m Ω)MAX.	Saturation Current/ 饱和电流(A)
SDRH105R-1R8NC	1.8 \pm 30%	100KHz,1V	7.6	10.50
SDRH105R-2R7NC	2.7 \pm 30%	100KHz,1V	9.9	8.00
SDRH105R-3R3NC	3.3 \pm 30%	100KHz,1V	13.0	7.80
SDRH105R-4R7NC	4.7 \pm 30%	100KHz,1V	15.7	6.00
SDRH105R-6R8NC	6.8 \pm 30%	100KHz,1V	18.0	5.40
SDRH105R-8R2NC	8.2 \pm 30%	100KHz,1V	25.0	4.50
SDRH105R-100MC	10 \pm 20%	100KHz,1V	30.0	4.20
SDRH105R-120MC	12 \pm 20%	100KHz,1V	33.0	4.00
SDRH105R-150MC	15 \pm 20%	100KHz,1V	41.0	3.60
SDRH105R-180MC	18 \pm 20%	100KHz,1V	46.0	2.80
SDRH105R-220MC	22 \pm 20%	100KHz,1V	61	2.70
SDRH105R-270MC	27 \pm 20%	100KHz,1V	69	2.40
SDRH105R-330MC	33 \pm 20%	100KHz,1V	84	2.40
SDRH105R-390MC	39 \pm 20%	100KHz,1V	106	2.15
SDRH105R-470MC	47 \pm 20%	100KHz,1V	130	2.00
SDRH105R-560MC	56 \pm 20%	100KHz,1V	149	1.90
SDRH105R-680MC	68 \pm 20%	100KHz,1V	201	1.55
SDRH105R-820MC	82 \pm 20%	100KHz,1V	227	1.50
SDRH105R-101MC	100 \pm 20%	100KHz,1V	253	1.35
SDRH105R-121MC	120 \pm 20%	100KHz,1V	303	1.18
SDRH105R-151MC	150 \pm 20%	100KHz,1V	370	1.05
SDRH105R-181MC	180 \pm 20%	100KHz,1V	419	0.92
SDRH105R-221MC	220 \pm 20%	100KHz,1V	500	0.85
SDRH105R-271MC	270 \pm 20%	100KHz,1V	672	0.72
SDRH105R-331MC	330 \pm 20%	100KHz,1V	812	0.68
SDRH105R-391MC	390 \pm 20%	100KHz,1V	953	0.60
SDRH105R-471MC	470 \pm 20%	100KHz,1V	1289	0.57
SDRH105R-561MC	560 \pm 20%	100KHz,1V	1430	0.54
SDRH105R-681MC	680 \pm 20%	100KHz,1V	1599	0.50
SDRH105R-821MC	820 \pm 20%	100KHz,1V	1768	0.46
SDRH105R-102MC	1000 \pm 20%	100KHz,1V	1989	0.42

※ The saturation current when the inductance decreases to 65% of initial value. (Ta=25°C)